

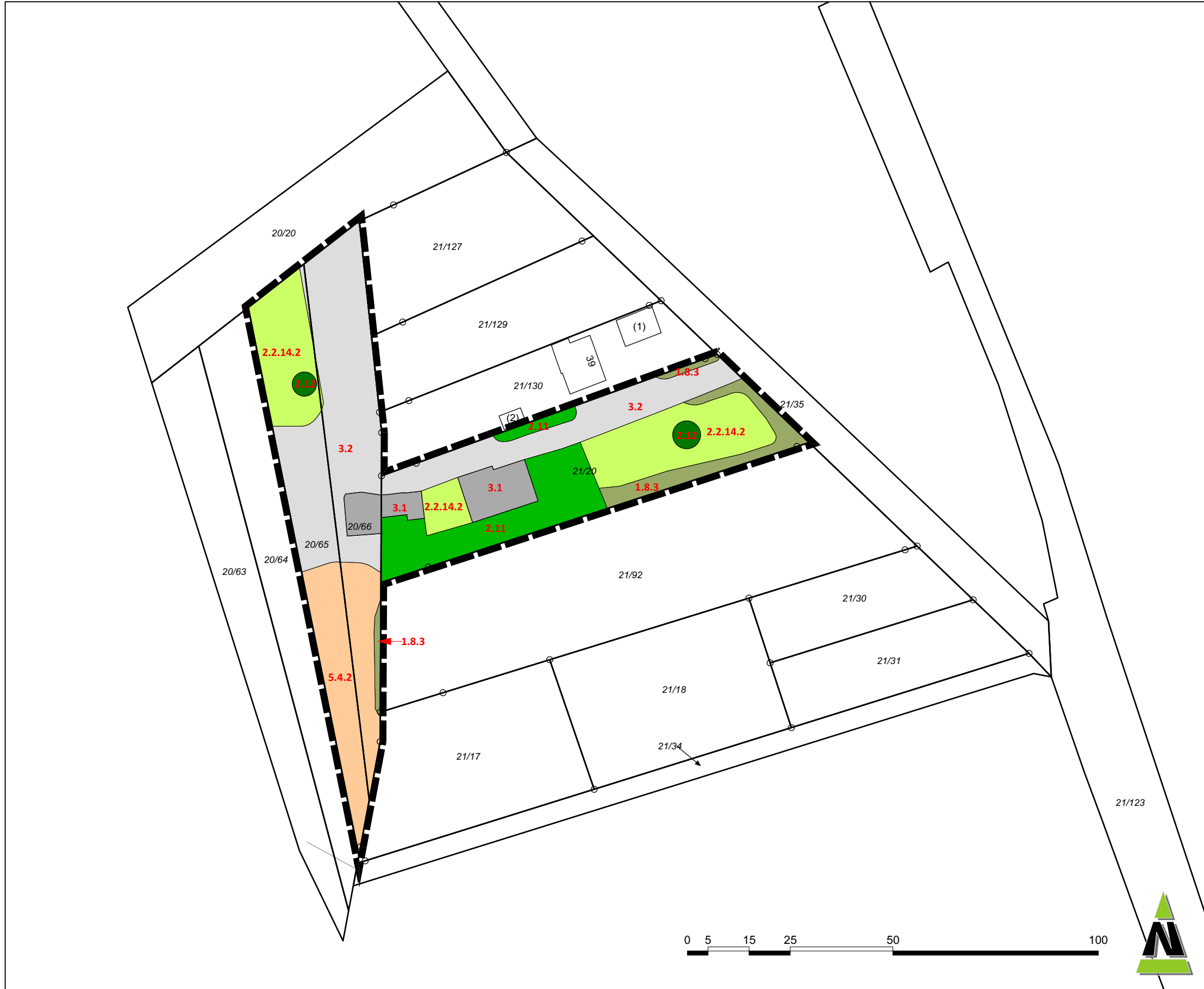

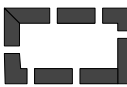







Biotypenbestandsplan im Jahr 2020



Legende

 Grenze Geltungsbereich Bebauungsplan

Biotypen

-  1.8.3 Gehölzstreifen, Gebüsch
-  2.2.14.2 Wiese frischer Standorte
-  2.11 Fichten-Feldgehölz
-  2.12 Baumgruppe, Einzelbaum
-  3.1 Vollversiegelte Fläche
-  3.2 Teilversiegelte Fläche
-  5.4.2 Aufschüttungsfläche